

REDSOLAR

M10 MBB Mono Module

108 Half Cells

Sliver frame or black frame



12 Years Product warranty

25 Years Linear power warranty

Integrated Solar Manufacturing & Technology Since 1964

390-410W

Output power

21.0%

Maximum efficiency

0~+5W

Power tolerance

Better Performance

Lower Heat Loss of Internal- resistance

Better Reliability

Reduce Shading & Risk of Micro Crack

Sleek & Stunning Looking

Powered by Semicore® SignatureBlack™ Technology

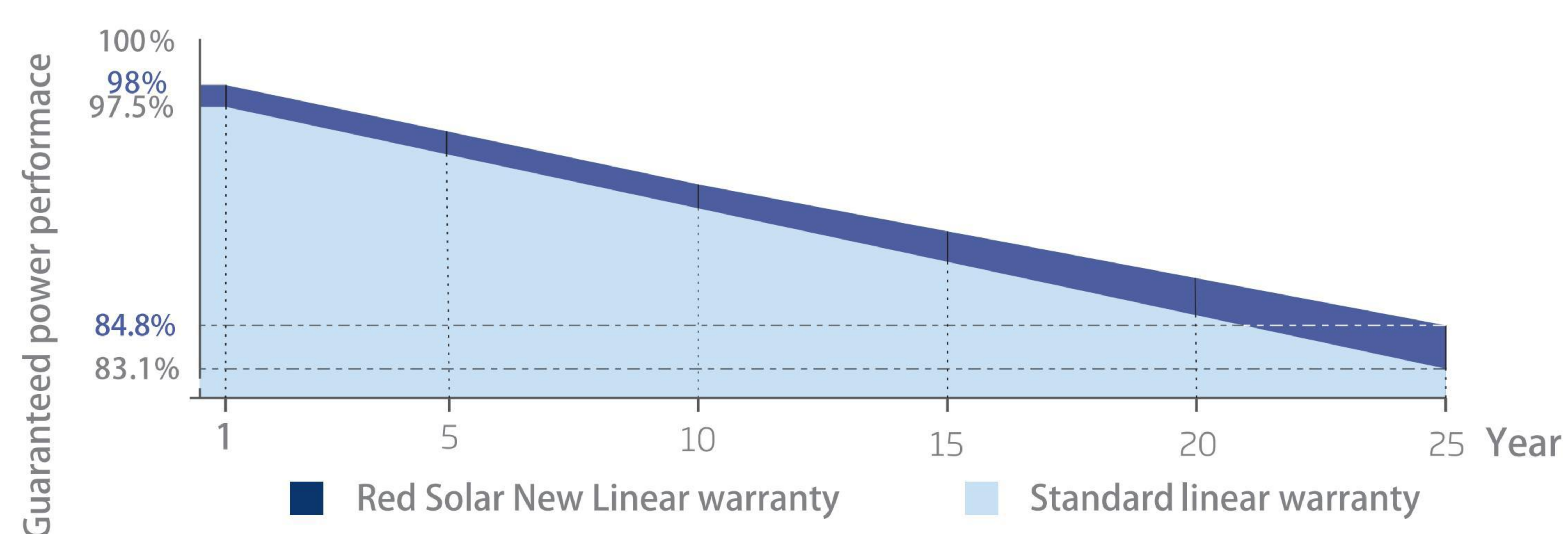

M10 MBB Monocrystalline Half-cell Module



Electrical Parameter(STC)					
Model	390M	395M	400M	405M	410M
Maximum power	390	395	400	405	410
Working point voltage	30.5	30.6	30.9	31.2	31.5
Working point current	12.87	12.99	13.01	13.06	13.07
Open circuit voltage	36.66	36.75	36.84	36.93	37.02
Short circuit current	13.65	13.71	13.77	13.84	13.91
PV module efficiency	20.0%	20.2%	20.5%	20.8%	21.0%
Standard test conditions	AM1.5, Irradiance 1000w/m ² , Cell Temperature 25°C				

Electrical Parameter(NMOT)					
Model	390M	395M	400M	405M	410M
Maximum power	285	288	292	296	300
Working point voltage	27.2	27.4	27.6	27.8	28.1
Working point current	10.48	10.52	10.58	10.64	10.69
Open circuit voltage	34.6	34.7	34.8	35.1	35.5
Short circuit current	11.03	11.08	11.13	11.19	11.24

NMOT The irradiance is 800W/m², the ambient temperature is 20 degrees, and the wind speed is 1m/s

The Electrical performance parameters are neither just referred to one PV panel, nor are a part of the contract; They are only used as reference.

P-V Curves of PV Module

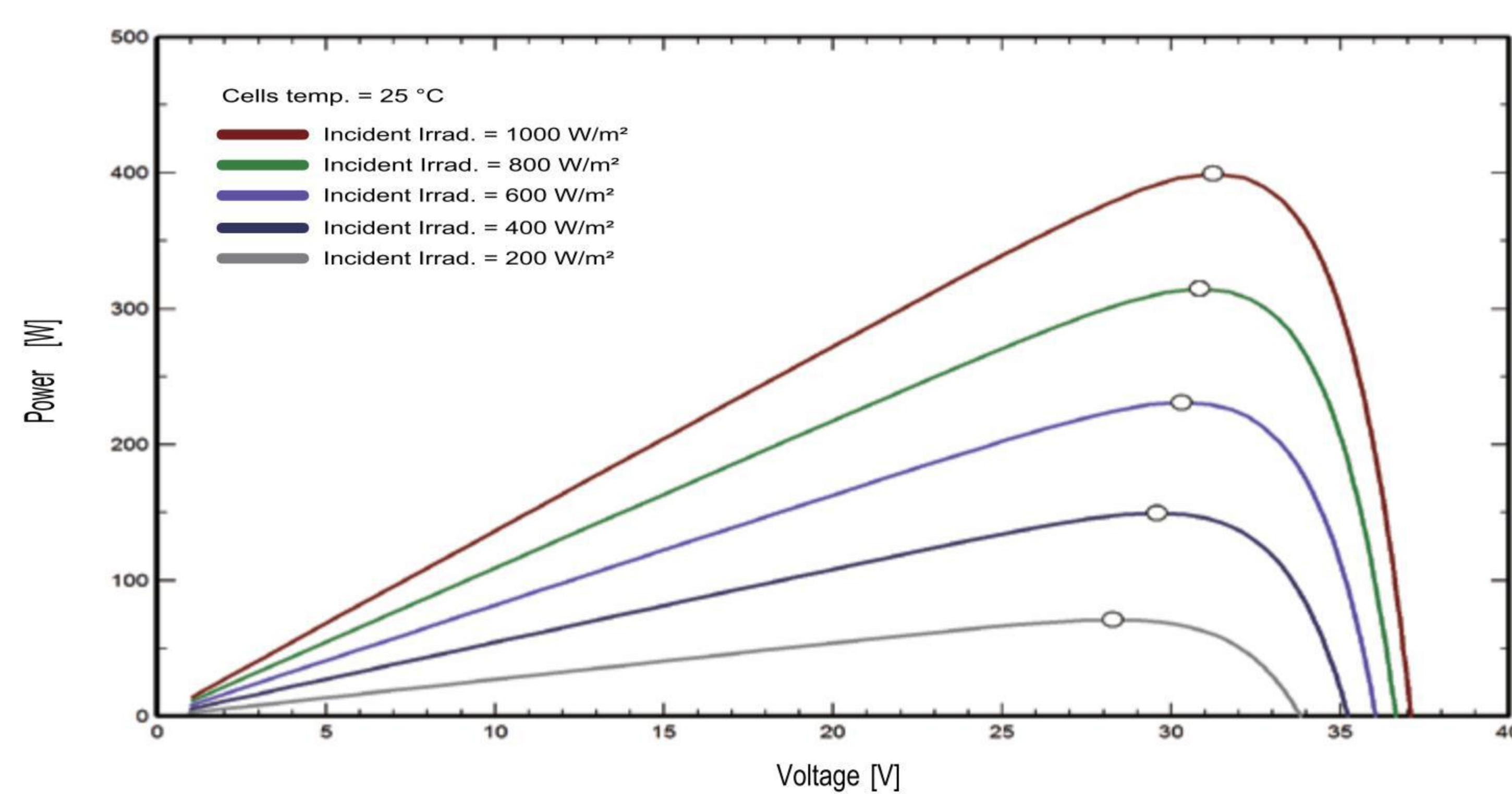

I-V Curves of PV Module

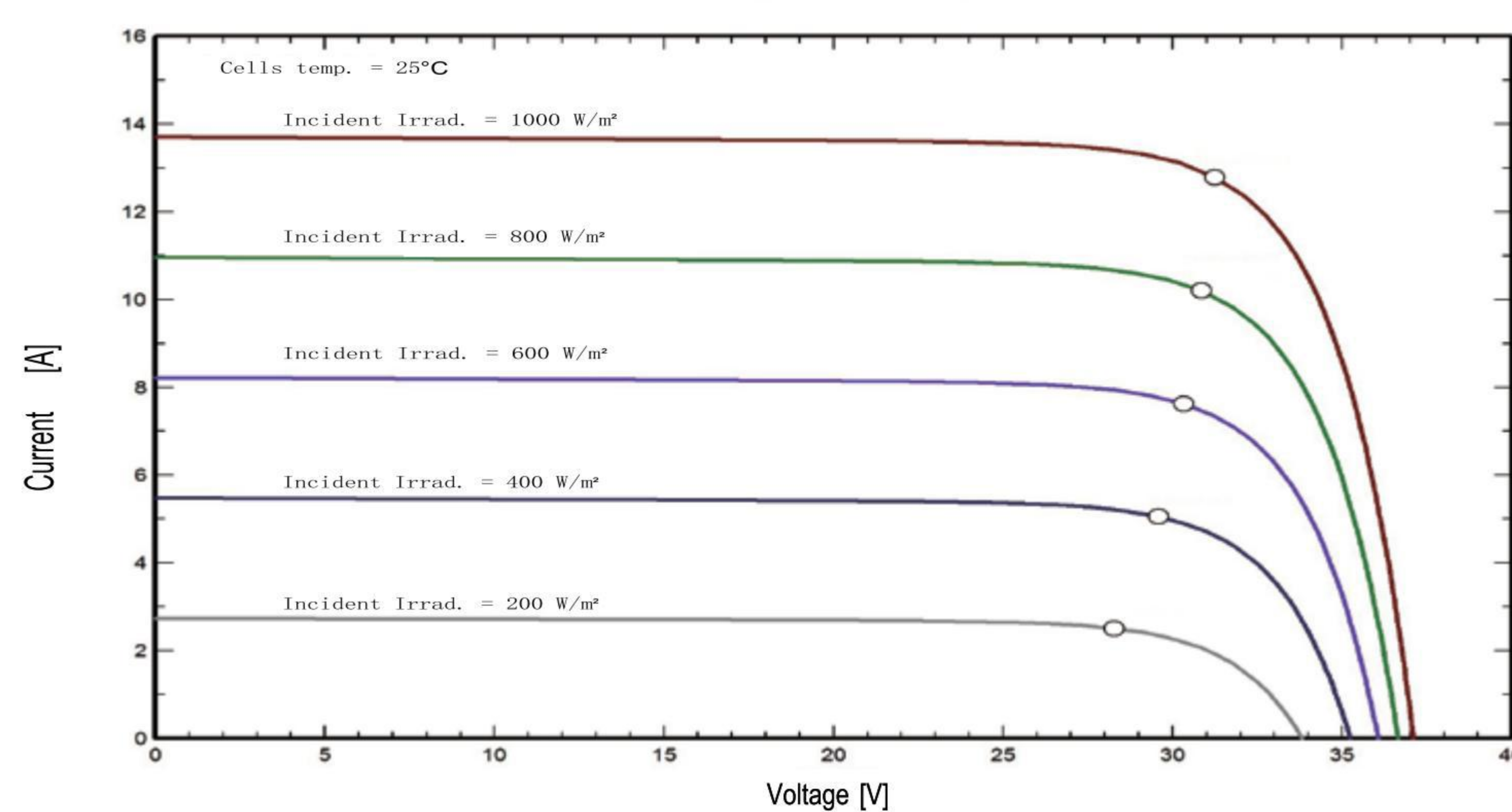

Model of PV Module Power Range
CETC-xxxM(H)/108 | 390 - 410W

PV Module Dimension

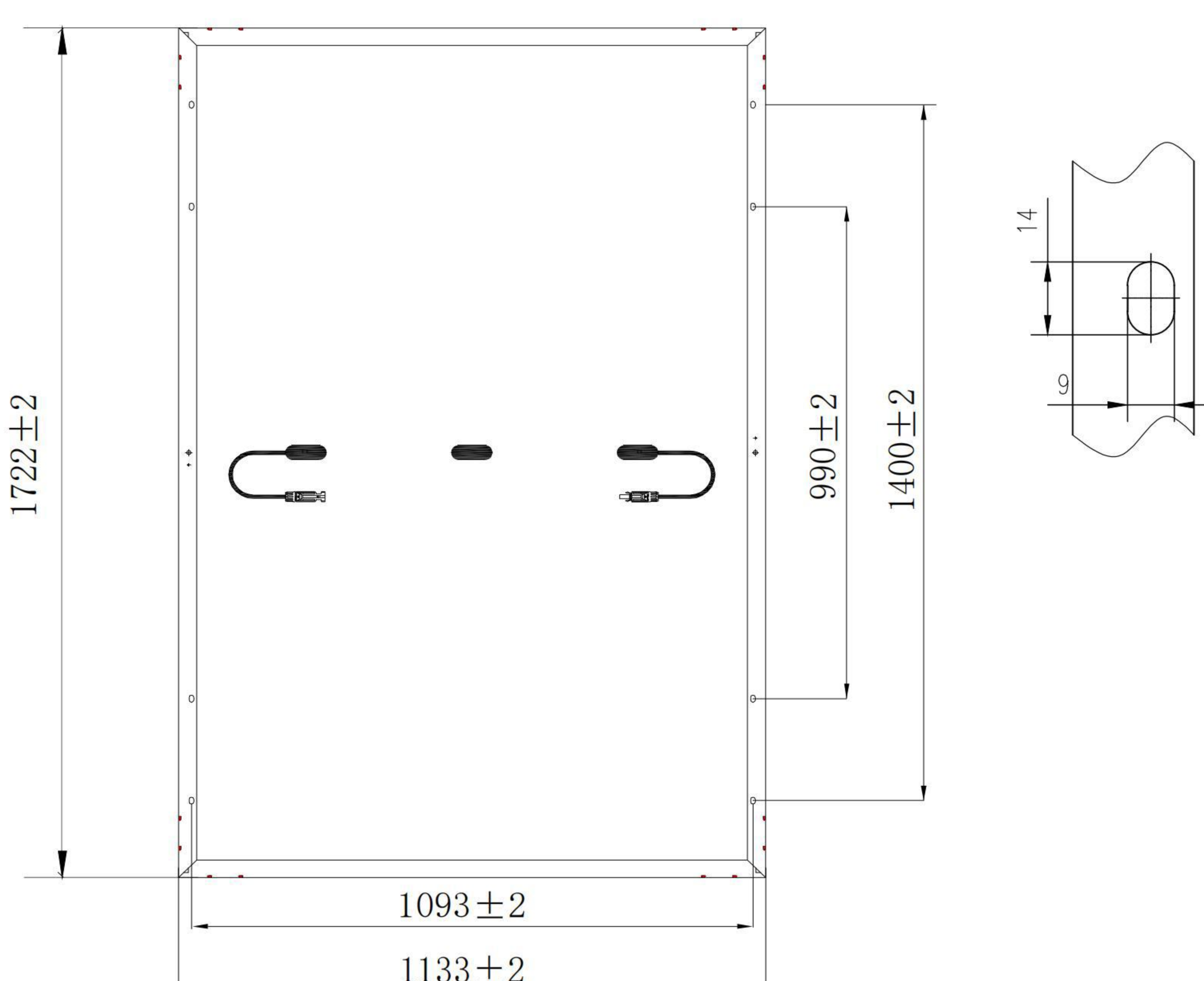

Mechanical Parameters

Module size	1722*1133*30mm
Number of solar cells	108(2*6*9)
Weight	20.5Kg ±5%
Junction Box	IP68, 3 diodes
Cables	4mm ² , 300mm, (Customizable)
Front plate glass	Ultra white AR coated toughened glass
Static load on the front	5400Pa
Static load on the back	2400Pa

Packaging&Transport

40'HQ container transport 36 Pcs/box × 26 box = 936 Pcs

Temperature Parameter

NMOT	45±2°C
Pmax	-0.35%/°C
Voc	-0.28%/°C
Isc	+0.05%/°C

Maximum Ratings

Working temperature	-40~+85°C
Maximum system voltage	1500VDC
Maximum fuse rated current	25A

